

*Enjoy the View!*



Proudly Distributed by:

COMMERCIAL **RECREATION** SPECIALISTS

877.896.8442 | [crs4rec.com](http://crs4rec.com)



*Scenic Shelters is a leading provider of high-quality wood and steel structures designed to enhance outdoor spaces. We specialize in crafting custom shelters, band shells, restrooms, and park and camp buildings using the highest quality materials. Our products are designed to blend seamlessly with nature, providing both functional and aesthetic solutions for parks, campsites, recreation areas, and other public spaces. Get out in nature and enjoy the view!*



# Table of Contents

## *Scenic Steel*

Project Spotlight - Steel	Page 5
Steel Open Gable	Page 6
Steel Hip	Page 7
Steel Barrel Vault	Page 8
Steel Hexagon	Page 9
Steel Octagon	Page 10
Steel Mini Gable	Page 11
Steel Cantilever	Page 12
Steel Pergola	Page 13
Steel Monoslope	Page 14
Steel Sports Shelter	Page 15

## *Scenic Wood*

Project Spotlight - Wood	Page 17
Wood Gothic Arch	Page 18
Wood Classic 8	Page 19
Wood Hexagon	Page 20
Wood Open Gable	Page 21
Wood Octagon	Page 22
Wood Enclosed Gable	Page 23
Wood Mini Gable	Page 24
Wood Hip	Page 25

## *Band Shells*

Band Shell - Project Spotlight	Page 27
Band Shell Info	Page 28-29

## *Scenic Buildings*

Project Spotlight - Building	Page 31
Building Info	Page 32-33
Building Photos	Page 34-35
Building Layouts	Page 36-37

## *Scenic Bridges*

Bridges	Page 38
---------	---------

## *Scenic Furnishings*

Furnishings	Page 39
-------------	---------

## *Scenic Stone & Solar*

Scenic Stone	Page 40
Scenic Solar	Page 41

## *Color Charts*

Color Charts	Page 42-43
--------------	------------

# Steel Shelters



# ON THE

# MAP

## ABOUT THIS PROJECT

Park Township -  
Holland, MI

The multiple Steel Hip Pavilion (SHP) shelters feature Terra Brown powdercoated frames, Patina Green metal roofs, and T&G roof decking.

The shelters were built in 2024 at the Holland Park Township pickleball courts located in Holland, MI. These structures provide shade and seating for guests while watching and enjoying pickleball.





# Steel Open Gable

*A quintessential gable steel shelter design*

Standard Features:

- Single-tier, double-tier, and split gable options
- 24-gauge metal roofing
- Factory applied powder coat finish on all steel components
- 4:12 roof pitch

*Standard Sizes*

<b>16 x 24</b>	<b>16 x 34</b>	<b>16 x 44</b>	<b>20 x 24</b>	<b>20 x 34</b>
<b>20 x 44</b>	<b>24 x 34</b>	<b>24 x 44</b>	<b>24 x 64</b>	<b>30 x 44</b>
<b>30 x 64</b>	<b>30 x 84</b>			



# Steel Hip

*A simple, yet timeless steel shelter design*

*Standard Sizes*

12 x 12	16 x 16	16 x 24	16 x 34	16 x 44
20 x 20	20 x 24	20 x 34	24 x 24	24 x 34
24 x 44	24 x 64	30 x 30	30 x 44	30 x 64
30 x 84	36 x 36			

Standard Features:

- Single-tier and double-tier options
- 24-gauge metal roofing
- Factory applied powder coat finish on all steel components
- 4:12 roof pitch



# Steel Barrel Vault

*A steel shelter with a curve*

Standard Features:

- Single-tier or double-tier options
- 24-gauge metal roofing
- Factory applied powder coat finish on all steel components

*Standard Sizes*

16 x 24	16 x 34	16 x 44	20 x 24	20 x 34
20 x 44	24 x 34	24 x 44	24 x 64	30 x 44
30 x 64	30 x 84			



# Steel Hexagon

*A timeless steel shelter design*

Standard Sizes				
16	20	24	28	36
40	50			

Standard Features:

- Single-tier and double-tier options
- 24-gauge metal roofing
- Factory applied powder coat finish on all steel components
- 4:12 roof pitch



# Steel Octagon

*A statement steel shelter design*

Standard Features:

- Single-tier and double-tier option
- 24-gauge metal roofing
- Factory applied powder coat finish on all steel components
- 4:12 roof pitch

*Standard Sizes*

16	20	24	28	36
40	50			



# Steel Mini Gable

*A smaller take on a classic steel shelter design*

Standard Features:

- 24 gauge metal roofing
- Factory applied powder coat finish on all steel components
- Benches, tables, or message center available
- 4:12 roof pitch

Standard Sizes				
8 x 8	10 x 10			



# Steel Cantilever

*A modern steel shelter design*

Standard Features:

- 24-gauge metal roofing
- Factory applied powder coat finish on all steel components
- 3:12 roof pitch

*Standard Sizes*

<b>8 x 24</b>	<b>8 x 28</b>	<b>8 x 32</b>		



# Steel Pergola

*A filtered sunlight steel shelter design*

## *Standard Sizes*

Scenic Shelters offers a variety of steel pergola styles. Certified welders and craftsmen create a tubular steel frame utilizing clear-span design. Pergolas are shipped ready to assemble with no cutting or welding required. A factory applied powder coat finish is standard on all steel components.

## Standard Features:

- Factory applied powder coat finish on all steel components
- A variety of styles and options available in column, supporting beam, and member designs
- Scenic Shelters' design team can design a pergola specific to a project's needs



# Steel Monoslope

*A steel shelter that's striking at every angle*

Standard Features:

- 24-gauge metal roofing
- Factory applied powder coat finish on all steel components
- 3:12 roof pitch

*Standard Sizes*

<b>8 x 24</b>	<b>8 x 28</b>	<b>8 x 32</b>		



# Steel Sports Shelter

*Protection with a contemporary steel shelter design*

Standard Sizes				
8 x 24	8 x 28	8 x 32		

Standard Features:

- 24-gauge metal roofing
- Factory applied powder coat finish on all steel components
- 3:12 roof pitch
- Custom sizes are available
- Benches are optional



# Wood Shelters

# ON THE

# MAP

## ABOUT THIS PROJECT

Veteran's Memorial Park -  
Rolla, MO

This massive Wood Open Gable (WOG) shelter features 16 columns which support a large 29 gauge metal roof.

The shelter was built in 2022 at the Veteran's Memorial Park in Rolla, MO. The structure provides an abundant amount of coverage for multiple picnic tables and seats.





# Wood Gothic Arch

*A wood shelter design reminiscent of years past*

Standard Features:

- Glulam SYP arches and rafters/columns
- #1 grade kiln dried 2" x 6" SYP roof decking
- 2" x 8" Cedar fascia
- 30-year architectural grade shingles
- Powder coated metal base shoes
- 4:12 roof pitch

*Standard Sizes*

<i>Standard Sizes</i>				
<b>24 x 44</b>	<b>24 x 52</b>	<b>28 x 36</b>	<b>28 x 44</b>	<b>28 x 52</b>
<b>34 x 44</b>	<b>34 x 52</b>	<b>44 x 60</b>		



# Wood Classic 8

*A classic wood shelter design*

## Standard Sizes

16 x 20	16 x 28	16 x 36	20 x 20	20 x 28
20 x 36	20 x 44	20 x 52	24 x 28	24 x 36
24 x 44	24 x 52	24 x 60	30 x 36	30 x 44
30 x 52	30 x 60	30 x 68	40 x 44	40 x 52
40 x 60	40 x 68	40 x 76	40 x 84	50 x 52

## Standard Features:

- Overall dimensions include a 24" overhang
- Glulam Port Orford Cedar columns & SYP beams
- #1 grade kiln dried 2" x 6" SYP roof decking
- 2" x 8" Cedar fascia
- 30-year architectural grade shingles
- Powder coated brackets, galvanized hardware
- 3:12 roof pitch



# Wood Hexagon

*An enduring wood shelter design*

Standard Features:

- Glulam Port Orford Cedar columns
- Glulam SYP beams and purlins
- #1 grade kiln dried 2" x 6" SYP roof decking
- 2" x 8" Cedar fascia
- 30-year architectural grade shingles
- Powder coated brackets
- Galvanized hardware
- 4:12 roof pitch

*Standard Sizes*

<b>16</b>	<b>20</b>	<b>24</b>	<b>30</b>	<b>32</b>
<b>35</b>	<b>36</b>	<b>40</b>	<b>45</b>	<b>50</b>



# Wood Open Gable

*A wood shelter with a rustic gable design*

## Standard Sizes

16 x 20	16 x 28	20 x 28	20 x 36	24 x 28
24 x 36	24 x 44	28 x 36	28 x 44	28 x 52
34 x 44	34 x 52	34 x 60	34 x 76	44 x 60

## Standard Features:

- Overall dimensions include a 24" overhang
- Glulam Port Orford Cedar columns
- Glulam SYP trusses
- #1 grade kiln dried 2" x 6" SYP roof decking
- 30-year architectural grade shingles
- 4:12 roof pitch



# Wood Octagon

*A statement wood shelter design*

Standard Features:

- Glulam Port Orford Cedar columns
- Glulam SYP beams and purlins
- #1 grade kiln dried 2" x 6" SYP roof decking
- 2" x 8" Cedar fascia
- 30-year architectural grade shingles
- Powder coated brackets
- Galvanized hardware
- 4:12 roof pitch

*Standard Sizes*

26	30	34	36	40
45	60			



# Wood Enclosed Gable

*An enclosed gable wood shelter design*

Standard Sizes				
16 x 20	16 x 28	20 x 28	20 x 36	24 x 28
24 x 36	24 x 44	28 x 36	28 x 44	28 x 52
34 x 44	34 x 52	34 x 60	34 x 76	44 x 60

Standard Features:

- Overall dimensions include a 24" overhang
- Glulam Port Orford Cedar columns
- Glulam SYP trusses
- 2" x 6" T&G roof deck
- 2" x 8" Cedar fascia
- 30-year architectural grade shingles
- Enclosed wood gable ends
- Multiple roof truss designs available
- 4:12 roof pitch



# Wood Mini Gable

*A smaller take on a classic wood shelter design*

Standard Features:

- Glulam Port Orford Cedar columns
- Glulam SYP beams and rafters
- #1 grade kiln dried 2" x 6" SYP roof decking
- 30-year architectural grade shingles
- Cedar fascia
- Benches, tables, or message center available
- 4:12 roof pitch

*Standard Sizes*

<b>8 x 8</b>	<b>10 x 10</b>			



# Wood Hip

*A simple, yet timeless wood shelter design*

Standard Sizes				
12 x 12	16 x 16	20 x 20	24 x 24	24 x 28
32 x 32	36 x 36	40 x 40		

Standard Features:

- Glulam Port Orford Cedar columns
- Glulam SYP beams and purlins
- #1 grade, kiln dried 2" x 6" SYP roof decking
- 30-year architectural grade shingles
- 2" x 8" Cedar fascia
- 4:12 roof pitch



# Band Shells

# ON THE

# MAP

## ABOUT THIS PROJECT

Levings Lake -  
Rockford, IL

This incredible Band Shell showcases a beautiful wood roof canopy and multiple light fixtures. Two dressing room areas rest on either side of the architectural, perforated wall.

The shelter was built in 2023 at Levings Lake in Rockford, IL. Whether hosting live music, theater productions, or public speaking events, the Band Shell serves as a focal point for cultural expression and connection.

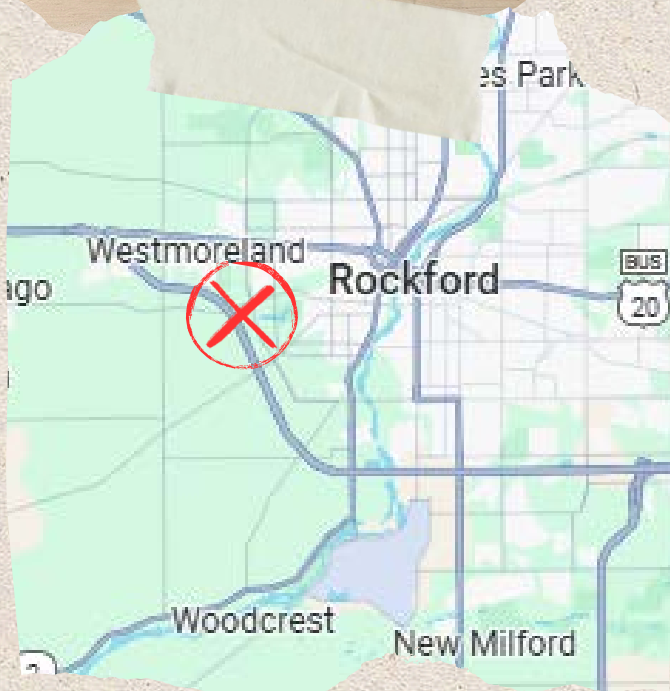



# Band Shell

*An impressive and functional wood structure design*

Scenic Shelters offers a variety of sleek band shell styles. With their graceful curves and substantial presence, these structures offer an impressive space for communities to come together. Scenic Shelters can create the perfect band shell for a project's aesthetic and functional needs.



# Band Shell

## Pre-Engineered Designs

- Each band shell is pre-engineered to meet or exceed local building requirements
- Stamped and sealed drawings and calculations completed by a structural engineer to meet a project's state and local building codes

## Roofing

- #1 grade kiln dried 2" x 6" SYP roof decking
- 2" x 8" Cedar fascia
- 30-year architectural grade shingle package

## Structure Frame

- Glulam Southern Yellow Pine (SYP)
- Each shelter is designed to meet the local snow and wind loads
- All metal connectors have a factory applied powder coat finish in Railing Black

## Columns

- Gothic arch style glue-laminated SYP columns are either direct embedded in concrete footings or attached at the surface utilizing metal base shoes

A photograph of a modern wooden building with a grey door and a white script overlay reading "Scenic Buildings". The building features horizontal wood siding and a dark roof. The text is centered over a semi-transparent grey rectangular area.

*Scenic  
Buildings*

# ON THE

# MAP

## ABOUT THIS PROJECT

Lincoln Park  
Community Lake -  
Lincoln Park, NJ

This amazing Building Activity Center (BAC) features a large shaded area connected to an enclosed storage building and office space.

The multiuse building was built in 2025 at Lincoln Park in Lincoln Park, NJ. The structure provides a spacious storage room for equipment as well as the perfect covered spot for gathering around multiple picnic tables.

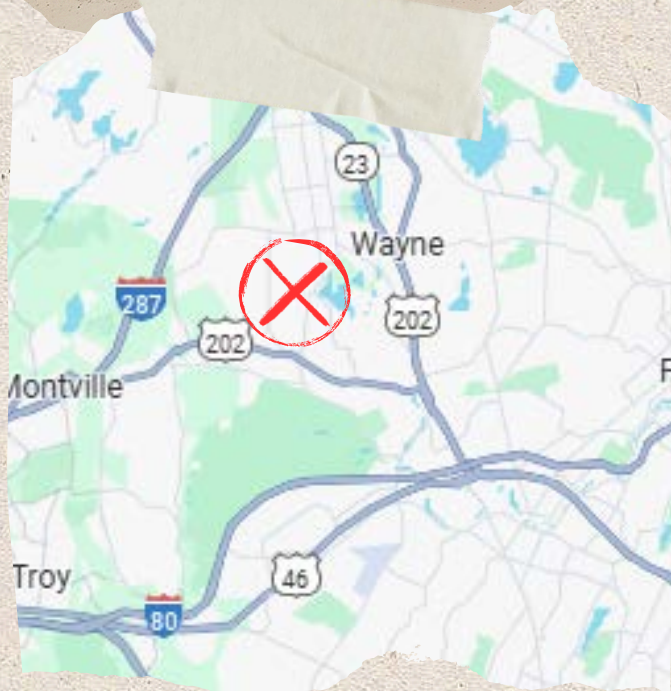

# Scenic Buildings

Scenic Shelters creates both standard and custom Cedar wood building activity centers. We can help you design a building that will meet your needs while offering an option that fits in your natural surroundings. Optional electrical and plumbing packages are available as well as MEP design plans for an additional charge.

## Standard Features

### Pre-Engineered Designs

- Each structure is pre-engineered to meet or exceed local building requirements
- Stamped and sealed drawings with calculations completed by a structural engineer to meet state and local building codes
- Restroom facilities meet ADA compliance requirements

## Cedar Timbers

- Milled from Northern White Cedar for natural beauty, durability, and structural integrity
- Nominal solid 4" x 8" double tongue and groove timbers
- Disassembled and delivered to the construction site
- Cedar is highly desirable for its resistance to moisture, warpage, insects, and fungus that can shorten the service life of other wood buildings
- Cedar's cellular structure also offers a natural thermal efficiency





### Exterior Wall Construction

- Predrilled starter holes for 10" coated screws speed construction of solid timbers
- Timbers are precut to length assuring staggered end joints and end matched for alignment, preassembled, and construction coded to ensure an easy field fit
- Disassembled and delivered to the construction site for reassembly
- Standard corners augment construction strength, reliability, and weather seal with a 6" timber screw
- Treated bottom plate with a sill seal and energy seal for all courses
- Trim package included for base, corners, and roofline

### Roofing/Roofline

- #1 grade kiln dried 2" x 6" SYP roof decking
- 2" x 8" cedar fascia
- 30-year architectural asphalt shingle package
- Low pitch laminated SYP beams with Port Orford Cedar columns and 24" overhang

### Doors & Windows

- Items are shipped to the job site ready for installation
- Primed steel doors with 3-part frame
- Standard hardware includes handles, locks, hinges, closer, and sweep

### Interior Walls

- Interior walls use standard 2" x 4" construction
- Fiberglass Reinforced Panel (FRP) in the restroom areas for easy cleaning
- Multipurpose areas are finished onsite with provided 1" x 8" T&G prime or cedar
- Trim package included for base, corners, ceiling, doors, windows, and vents







# Building Layouts

## Prefabricated Concession Hub

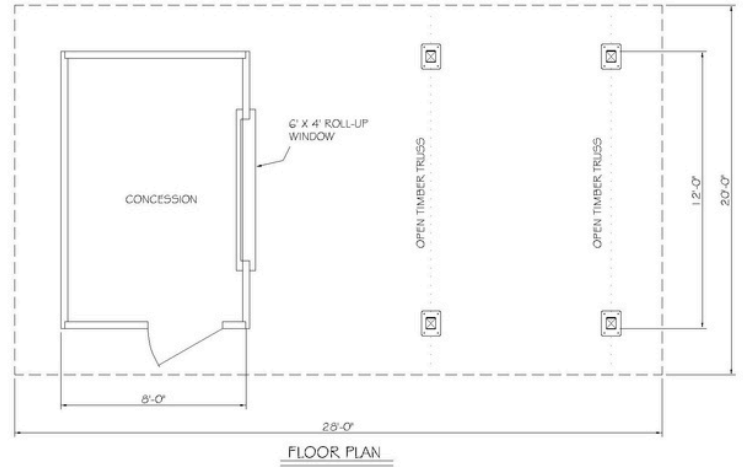
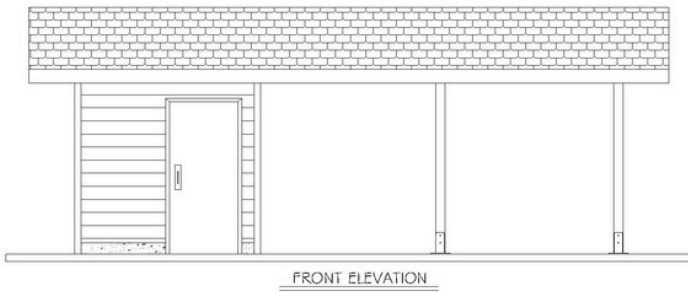

## Prefabricated Comfort Station

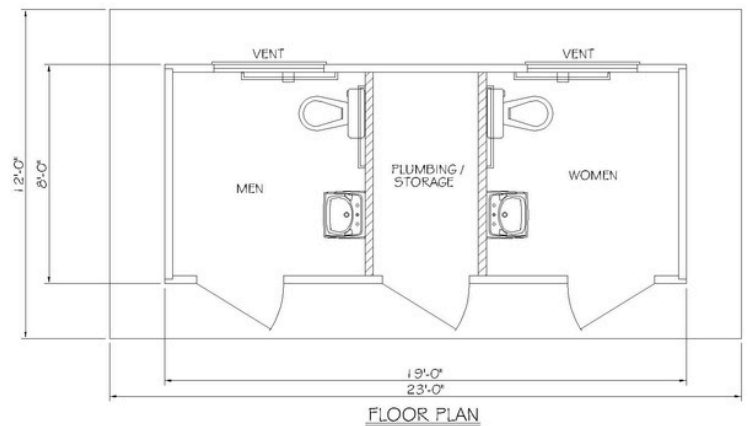

# Building Layouts

## Prefabricated Amenity Building

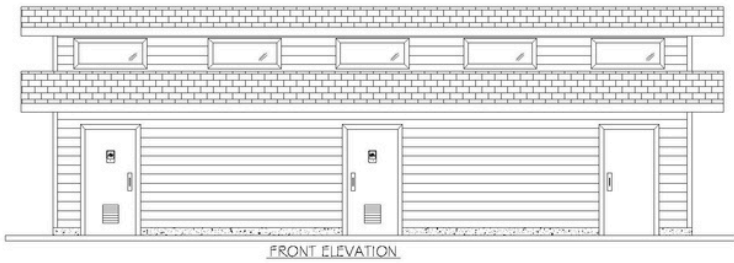

FRONT ELEVATION

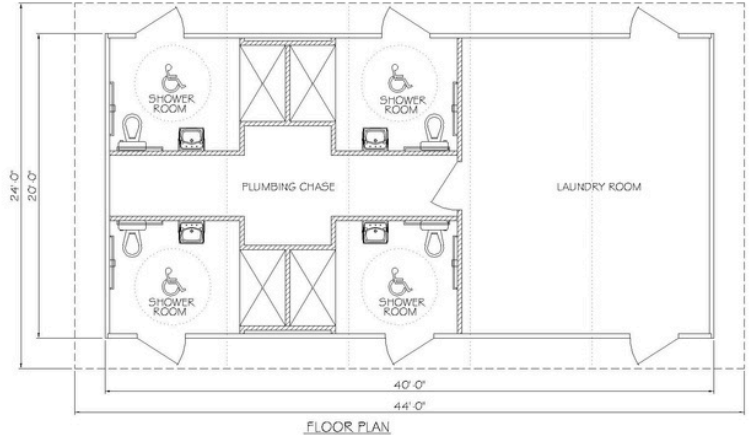

FLOOR PLAN

## Prefabricated Recreation Hub

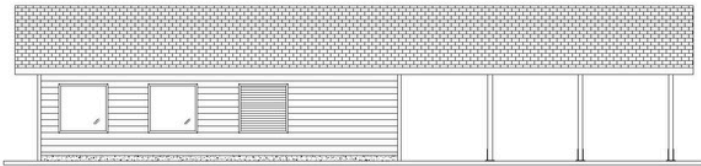

FRONT ELEVATION



FLOOR PLAN

# Scenic Bridges



Scenic Shelters' bridges are designed to combine both beauty and function. Our bridges can be used in a variety of settings for pedestrian and light vehicular traffic. The pre-engineered bridges can span 16' – 80' in length and are available in 4', 6', or 8' widths. Bridges feature glulam SYP wood components, 2" x 6" SYP decking, and hot dipped galvanized steel hardware. Built with the finest materials, Scenic Shelters' bridges are sure to be an eye-catching feature to your outdoor setting.

## Options:

- 5-Rail or 4-rail plus curb railing option
- Various deck widths
- Assorted bridge spans
- Choice of flat or cambered bridge style
- Custom features and sizes available upon request

# Scenic Furnishings

## Tables

- Choose from surface mount or freestanding
- Variety of frame and Thermoplastic colors
- Choice of Diamond (D) or Perforated (P) pattern
- Rectangular tables available in 4', 6' or 8' lengths, extended lengths and ADA accessible
- Round or square tables available in 46" length



H-TS-R(D)



S-TS-R(P)



H-TS-S(D)



H-TS-C(P)

## Benches

- Choose from surface mount, freestanding, in-ground, or wall mount
- Variety of frame and Thermoplastic colors to choose from
- Option of Diamond (D) or Perforated (P) pattern
- Available in multiple lengths



H-BS(D)



S-BS(P)



S-BS



H-BS(P)

## Trash Receptacles and Extras

- 32 gallon capacity
- Available in Diamond (D) or Perforated Rolled (P) pattern
- Variety of Thermoplastic colors to choose from
- Plastic liner and lid included
- Choice of bonnet, flat, or dome lid
- Portable design with an available mounting kit (sold separately)



S-RS



H-RS(P)



Grill



Bike Rack

Many products, options, sizes, and colors are available. Contact Scenic Shelters for all your furnishing needs.

# Scenic Stone



- Enhance your building or shelter by adding Scenic Shelters' cost effective faux stone wainscoting kits and/or column wraps
- Commercial grade faux stone includes a dual layer composite system made with an impact resistant plastic layer and solid urethane layer for maximum protection
- Wainscoting panels have a built-in top ledge making them ready for simple installation
- Column wrap kits come with 4 side pieces and a 2-piece limestone cap. Standard size measures 27" x 27" with a 28" x 28" limestone cap.
- A large variety of stone colors and patterns are available



# Scenic Solar



















Photos Courtesy of FlightDeck Brewing

- Solar kits include: solar panel(s), battery backup, inverter, and wiring harness
- Powering Options: lights, fans, outlets, cell phone charger, and motion detectors
- Lockable security case to securely hold the battery and inverter is included
- Kits can be custom designed to fulfill your project's needs
- Perfect for remote locations that are off-grid

# Steel Color Charts

## Standard Colors

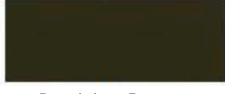
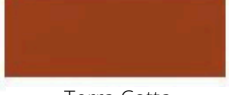
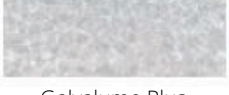





					
Regal White	Bone White	Surrey Beige	Sandstone	Almond	Buckskin
					
Ash Gray	Slate Gray	Charcoal	Matte Black	Medium Bronze	Dark Bronze
					
Patina Green	Evergreen	Mansard Brown	Colonial Red	Roman Blue	Patrician Bronze
					
Terra Cotta	Galvalume Plus				

## 24 Gauge Metal Roofing Color Options

## Deep Tone Premium Colors

			
Brite Red	Brandywine	Regal Blue	Hartford Green

## Metallic Colors

					
Prewathered Galvalume	Leadcoat	Silver Metallic	Copper Penny Metallic	Texas Silver Metallic	Champagne Metallic

## Powder Coat Color Options

					
Traffic White RAL 9016	Cream RAL 9001	Grey White RAL 9002	Beige RAL 1001	Brown Gray RAL 7013	Jet Black RAL 9005
					
Terra Brown RAL 8028	Brown Green RAL 6008	Beige Brown RAL 8024	Copper Brown RAL 8004	Red Brown RAL 8012	Telegrey RAL 7045
					
Ocean Blue RAL 5020	Brilliant Blue RAL 5007	Mint Turquoise RAL 6033	Mint Green RAL 6029	Tarpaulin Grey RAL 7010	Silk Grey RAL 7044
					
Sepia Brown RAL 8014	Stone Grey RAL 7030	Moss Green RAL 6005	Grey Blue RAL 5008	Dusty Gray RAL 7037	Traffic Red RAL 3020

# Wood Color Charts

## 29 Gauge Metal Roofing Color Options



## Shingle Color Options



## Stain Color Options





Proudly Distributed by:

COMMERCIAL **RECREATION** SPECIALISTS

877.896.8442 | [crs4rec.com](http://crs4rec.com)